



US Army Corps
of Engineers
Omaha District

CHAPEL - SMALL ENHANCED COMMUNITY MINISTRY SERIES ARMY STANDARD DESIGN

VARIOUS LOCATIONS (CONUS)

INDEX

DESIGN FILE	SHEET NO.	DESCRIPTION
RF-SECG-001.DGN	G-001	COVER
RF-SECG-002.DGN	G-003	ABBREVIATIONS
RF-SECG-003.DGN	G-004	LEGEND
RF-CSC-101.DGN	C101	SMALL ENHANCED CHAPEL SITE PLAN
RF-SECA-110.DGN	A-110	FIRST FLOOR PLAN
RF-SECA-120.DGN	A-120	MEZZANINE PLAN
RF-SECI-110.DGN	I-110	FIRST FLOOR FURNITURE PLAN
RF-SECI-111.DGN	I-111	FIRST FLOOR FURNITURE ALTERNATE LAYOUTS
RF-SECI-120.DGN	I-120	MEZZANINE FURNITURE PLAN

THIS PROJECT WAS DESIGNED BY THE OMAHA DISTRICT OF THE US ARMY CORPS OF ENGINEERS. THE INITIALS OR SIGNATURES AND REGISTRATION DESIGNATIONS OF INDIVIDUALS APPEAR ON THESE PROJECT DOCUMENTS WITHIN THE SCOPE OF THEIR EMPLOYMENT AS REQUIRED BY ER 1110-1-8152.

THE FOLLOWING SIGNATURES BELOW INDICATE OFFICIAL APPROVAL OF ALL DRAWINGS IN THIS SET DATED _____

SUBMITTED BY:	RA
CHIEF: ARCH	SECTION
SUBMITTED BY:	PE
CHIEF: CIVIL	SECTION
SUBMITTED BY:	PE
CHIEF: ELECT	SECTION
SUBMITTED BY:	PE
CHIEF: ENVR	SECTION
SUBMITTED BY:	PE
CHIEF: MECH	SECTION
SUBMITTED BY:	PE
CHIEF: STRUCT/INTER	SECTION
SUBMITTED BY:	PE
CHIEF: GEOT	SECTION
SUBMITTED BY:	CADD
	PROJECT COORD.



US Army Corps
of Engineers
Omaha District

--	--	--	--	--	--	--	--	--	--	--	--	--	--	--	--	--	--	--	--	--	--	--	--	--	--	--	--	--	--	--	--	--	--	--	--	--	--	--	--	--	--	--	--	--	--	--	--	--	--	--	--	--	--	--	--	--	--	--	--	--	--	--	--	--	--	--	--	--	--	--	--	--	--	--	--	--	--	--	--	--	--	--	--	--	--	--	--	--	--	--	--	--	--	--	--	--	--	--	--	--	--	--	--	--	--	--	--	--	--	--	--	--	--	--	--	--	--	--	--	--	--	--	--	--	--	--	--	--	--	--	--	--	--	--	--	--	--	--	--	--	--	--	--	--	--	--	--	--	--	--	--	--	--	--	--	--	--	--	--	--	--	--	--	--	--	--	--	--	--	--	--	--	--	--	--	--	--	--	--	--	--	--	--	--	--	--	--	--	--	--	--	--	--	--	--	--	--	--	--	--	--	--	--	--	--	--	--	--	--	--	--	--	--	--	--	--	--	--	--	--	--	--	--	--	--	--	--	--	--	--	--	--	--	--	--	--	--	--	--	--	--	--	--	--	--	--	--	--	--	--	--	--	--	--	--	--	--	--	--	--	--	--	--	--	--	--	--	--	--	--	--	--	--	--	--	--	--	--	--	--	--	--	--	--	--	--	--	--	--	--	--	--	--	--	--	--	--	--	--	--	--	--	--	--	--	--	--	--	--	--	--	--	--	--	--	--	--	--	--	--	--	--	--	--	--	--	--	--	--	--	--	--	--	--	--	--	--	--	--	--	--	--	--	--	--	--	--	--	--	--	--	--	--	--	--	--	--	--	--	--	--	--	--	--	--	--	--	--	--	--	--	--	--	--	--	--	--	--	--	--	--	--	--	--	--	--	--	--	--	--	--	--	--	--	--	--	--	--	--	--	--	--	--	--	--	--	--	--	--	--	--	--	--	--	--	--	--	--	--	--	--	--	--	--	--	--	--	--	--	--	--	--	--	--	--	--	--	--	--	--	--	--	--	--	--	--	--	--	--	--	--	--	--	--	--	--	--	--	--	--	--	--	--	--	--	--	--	--	--	--	--	--	--	--	--	--	--	--	--	--	--	--	--	--	--	--	--	--	--	--	--	--	--	--	--	--	--	--	--	--	--	--	--	--	--	--	--	--	--	--	--	--	--	--	--	--	--	--	--	--	--	--	--	--	--	--	--	--	--	--	--	--	--	--	--	--	--	--	--	--	--	--	--	--	--	--	--	--	--	--	--	--	--	--	--	--	--	--	--	--	--	--	--	--	--	--	--	--	--	--	--	--	--	--	--	--	--	--	--	--	--	--	--	--	--	--	--	--	--	--	--	--	--	--	--	--	--	--	--	--	--	--	--	--	--	--	--	--	--	--	--	--	--	--	--	--	--	--	--	--	--	--	--	--	--	--	--	--	--	--	--	--	--	--	--	--	--	--	--	--	--	--	--	--	--	--	--	--	--	--	--	--	--	--	--	--	--	--	--	--	--	--	--	--	--	--	--	--	--	--	--	--	--	--	--	--	--	--	--	--	--	--	--	--	--	--	--	--	--	--	--	--	--	--	--	--	--	--	--	--	--	--	--	--	--	--	--	--	--	--	--	--	--	--	--	--	--	--	--	--	--	--	--	--	--	--	--	--	--	--	--	--	--	--	--	--	--	--	--	--	--	--	--	--	--	--	--	--	--	--	--	--	--	--	--	--	--	--	--	--	--	--	--	--	--	--	--	--	--	--	--	--	--	--	--	--	--	--	--	--	--	--	--	--	--	--	--	--	--	--	--	--	--	--	--	--	--	--	--	--	--	--	--	--	--	--	--	--	--	--	--	--	--	--	--	--	--	--	--	--	--	--	--	--	--	--	--	--	--	--	--	--	--	--	--	--	--	--	--	--	--	--	--	--	--	--	--	--	--	--	--	--	--	--	--	--	--	--	--	--	--	--	--	--	--	--	--	--	--	--	--	--	--	--	--	--	--	--	--	--	--	--	--	--	--	--	--	--	--	--	--	--	--	--	--	--	--	--	--	--	--	--	--	--	--	--	--	--	--	--	--	--	--	--	--	--	--	--	--	--	--	--	--	--	--	--	--	--	--	--	--	--	--	--	--	--	--	--	--	--	--	--	--	--	--	--	--	--	--	--	--	--	--	--	--	--	--	--	--	--	--	--	--	--	--	--	--	--	--	--	--	--	--	--	--	--	--	--	--	--	--	--	--	--	--	--	--	--	--	--	--	--	--	--	--	--	--	--	--	--	--	--	--	--	--	--	--	--	--	--	--	--	--	--	--	--	--	--	--	--	--	--	--	--	--	--	--	--	--	--	--	--	--	--	--	--	--	--	--	--	--	--	--	--	--	--	--	--	--	--	--	--	--	--	--	--	--	--	--	--	--	--	--	--	--	--	--	--	--	--	--	--	--	--	--	--	--	--	--	--	--	--	--	--	--	--	--	--	--	--	--	--	--	--	--	--	--	--	--	--	--	--	--	--	--	--	--	--	--	--	--	--	--	--	--	--	--	--	--	--	--	--	--	--	--	--	--	--	--	--	--	--	--	--	--	--	--	--	--	--	--	--	--	--	--	--	--	--	--	--	--	--	--	--	--	--	--	--	--	--	--	--	--	--	--	--	--	--	--	--	--	--	--	--	--	--	--	--	--	--	--	--	--	--	--	--	--	--	--	--	--	--	--	--	--	--	--	--	--	--	--	--	--	--	--	--	--	--	--	--	--	--	--	--	--	--	--	--	--	--	--	--	--	--	--	--	--	--	--	--	--	--	--	--	--	--	--	--	--	--	--	--	--	--	--	--	--	--	--	--	--	--	--	--	--	--	--	--	--	--	--	--	--	--	--	--	--	--	--	--	--	--	--	--	--	--	--	--	--	--	--	--	--	--	--	--	--	--	--	--	--	--	--	--	--	--	--	--	--	--	--	--	--	--	--	--	--	--	--	--	--	--	--	--	--	--	--	--	--	--	--	--	--	--	--	--	--	--	--	--	--	--	--	--	--	--	--	--	--	--	--	--	--	--	--	--	--	--	--	--	--	--	--	--	--	--	--	--	--	--	--	--	--	--	--	--	--	--	--	--	--	--	--	--	--	--	--	--	--	--	--	--	--	--	--	--	--	--	--	--	--	--	--	--	--	--	--	--	--	--	--	--	--	--	--	--	--	--	--	--	--	--	--	--	--	--	--	--	--	--	--	--	--	--	--	--	--	--	--	--	--	--	--	--	--	--	--	--	--	--	--	--	--	--

ng6edx1bc



**US Army Corps
of Engineers®**
OMAHA DISTRICT

[illegible]

US ARMY ENGINEER DISTRICT CORPS OF ENGINEERS OMAHA, NEBRASKA	DESIGNED BY:	X	DATE:	SEPTEMBER 2012
	DWN BY:	X	SOLICITATION NO.:	Z
	SUBMITTED BY:	X	CONTRACT NO.:	Z
	PLOT SCALE:	1:1	PLOT DATE:	Z
	FILE NAME:	34x22" sheet, aead.dgn		

VARIOUS LOCATIONS
3D BIM TRANSLATION - ARMY STANDARD DESIGN
SMALL CHAPEL
ENHANCED COMMUNITY MINISTRY SERIES
FIRST FLOOR PLAN

**SHEET
IDENTIFICATION
A-110**

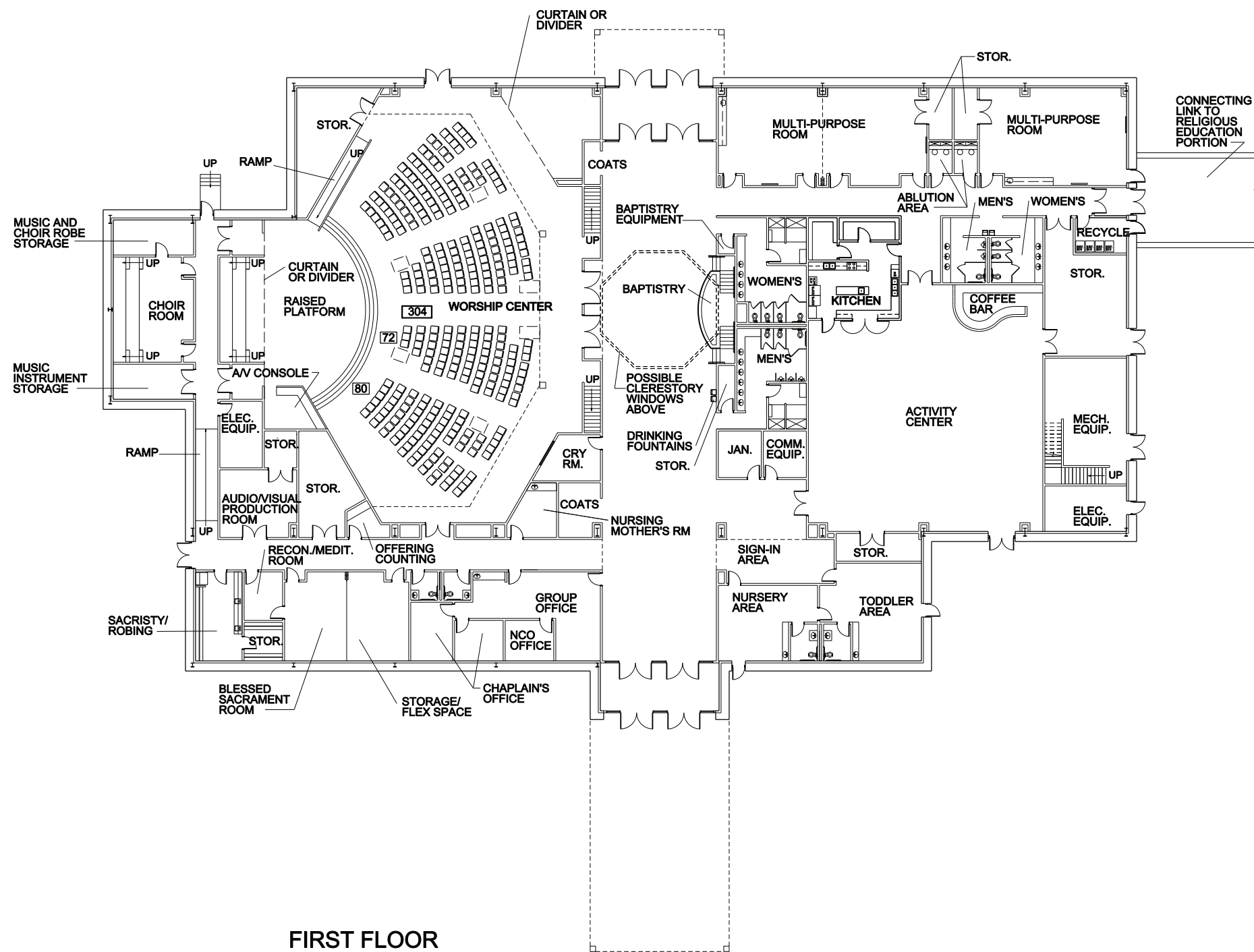

FIRST FLOOR

GENERAL NOTES:

1. REFER TO THE ARMY STANDARD AND ARMY STANDARD DESIGN DOCUMENTS FOR ALL FACILITY DESIGN REQUIREMENTS INCLUDING THOSE THAT MAY NOT BE ILLUSTRATED IN THESE PLANS.

2. THE LOCATION AND NUMBER OF BUILDING ACCESSORIES (MARKER BOARDS, TACK BOARD, TELEPHONE, ACCESSORIES, DIRECTORIES, ETC.) IS FLEXIBLE. PLEASE SEE ROOM FURNISHING REQUIREMENTS IN STANDARD DESIGN TEXT (AS WELL AS ANY APPLICABLE CODES AND CRITERIA) FOR SPECIFIC FURNISHING REQUIREMENTS. EACH INSTALLATION MAY ADD TO THESE REQUIRED FURNISHINGS TO THE EXTENT THAT THEY DO NOT CONFLICT WITH OTHER ARMY STANDARD DESIGN REQUIREMENTS.

3. THE NUMBER AND LOCATION OF MEDIA CONSOLES IS FLEXIBLE BASED ON THE NEEDS OF EACH INSTALLATION AND USER GROUP. THIS DOCUMENT ILLUSTRATES SOME OF THE POSSIBLE LOCATIONS FOR MEDIA CONSOLES. THE BALCONY MEDIA CONTROL CONSOLE IS REQUIRED BY THE ARMY STANDARD, BUT ALL OTHERS MAY BE IMPLEMENTED AS REQUIRED TO SUIT INDIVIDUAL NEEDS.

4. LOCATION OF OPTIONAL DROP CURTAIN AS REQUIRED PER SPECIFIC USER NEEDS.

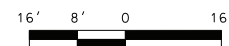

SCALE: $1/16'' = 1' - 0''$

D

C

B

A

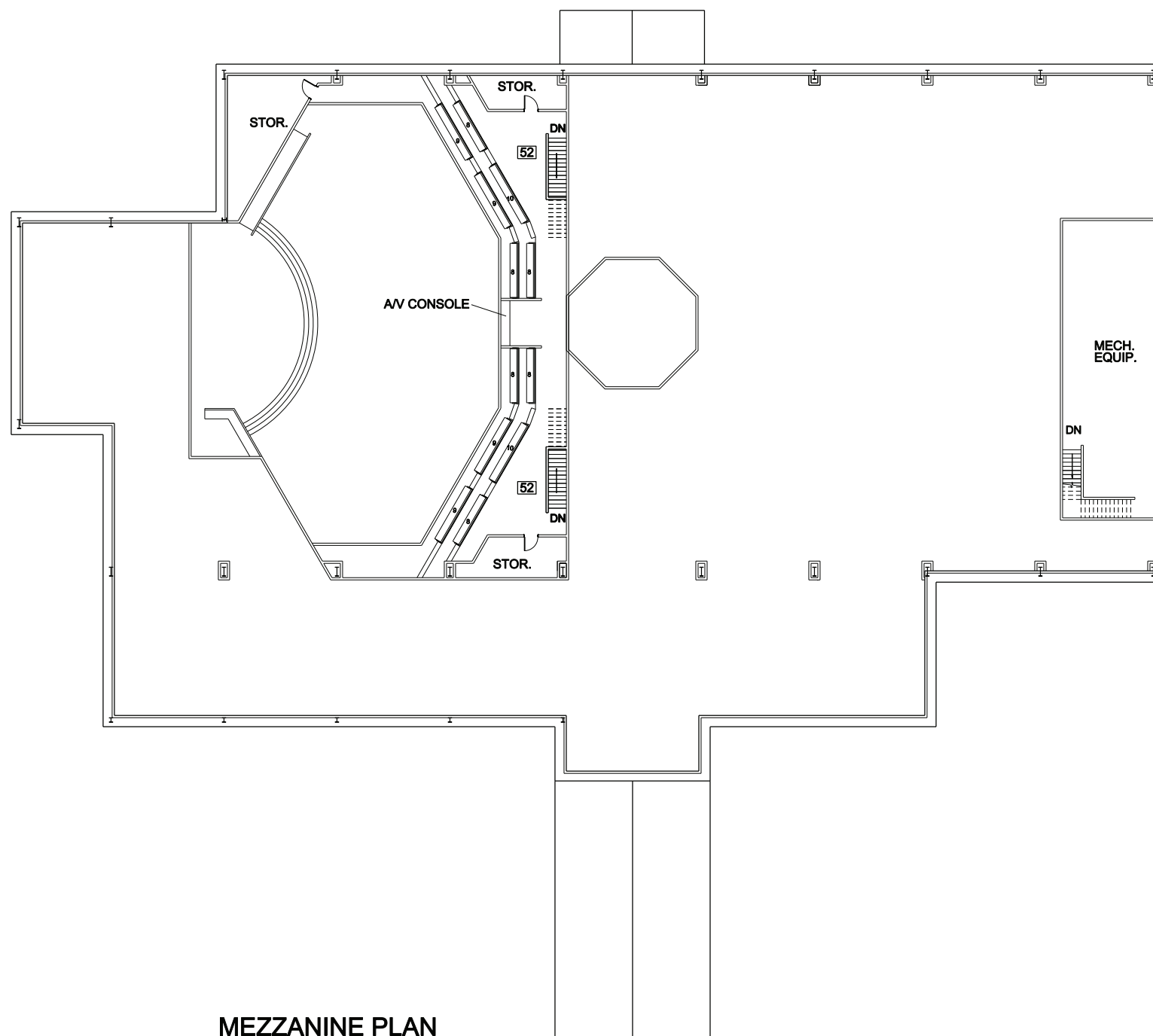

GENERAL NOTES:

1. REFER TO THE ARMY STANDARD AND ARMY STANDARD DESIGN DOCUMENTS FOR ALL FACILITY DESIGN REQUIREMENTS INCLUDING THOSE THAT MAY NOT BE ILLUSTRATED IN THESE PLANS.

2. THE LOCATION AND NUMBER OF BUILDING ACCESSORIES (MARKER BOARDS, TACK BOARDS, TOILET ACCESSORIES, DIRECTORIES, ETC.) IS FLEXIBLE. PLEASE SEE ROOM FURNISHING REQUIREMENTS IN STANDARD DESIGN SERIES, AS WELL AS ANY APPLICABLE CODES AND CRITERIA) FOR SPECIFIC FURNISHING REQUIREMENTS. EACH INSTALLATION MAY ADD TO THESE REQUIRED FURNISHINGS TO THE EXTENT THAT THEY DO NOT CONFLICT WITH OTHER ARMY STANDARD DESIGN REQUIREMENTS.

3. THE NUMBER AND LOCATION OF MEDIA CONSOLES IS FLEXIBLE BASED ON THE NEEDS OF EACH INSTALLATION AND USER GROUP. THIS DOCUMENT ILLUSTRATES SOME OF THE POSSIBLE LOCATIONS FOR MEDIA CONSOLES. THE BALCONY MEDIA CONTROL CONSOLE IS REQUIRED BY THE ARMY STANDARD, BUT ALL OTHERS MAY BE IMPLEMENTED AS REQUIRED TO SUIT INDIVIDUAL NEEDS.

4. LOCATION OF OPTIONAL DROP CURTAIN AS REQUIRED PER SPECIFIC USER NEEDS.

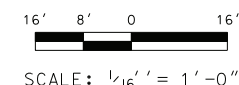

SCALE: $1/16'' = 1' - 0''$



**US Army Corps
of Engineers®**
OMAHA DISTRICT

[illegible]

US ARMY ENGINEER DISTRICT CORPS OF ENGINEERS OMAHA, NEBRASKA	DESIGNED BY:	X	DATE:	SEPTEMBER 2012
	DWN BY:	X	SOLICITATION NO.:	
	SUBMITTED BY:	X	CONTRACT NO.:	
	PLOT SCALE:	1:1	PLOT DATE:	
	SIZE:		FILE NUMBER:	
			FILE NAME:	

VARIOUS LOCATIONS
3D BIM TRANSLATION - ARMY STANDARD DESIGN
SMALL CHAPEL
ENHANCED COMMUNITY MINISTRY SERIES
MEZZANINE PLAN

**SHEET
IDENTIFICATION
A-120**

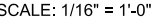

SCALE: 1/16" = 1'-0'

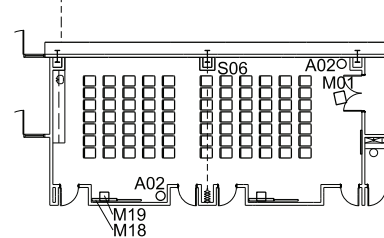

1 **ALTERNATE LAYOUT**
I-111
SCALE: 1/16" = 1'-0"

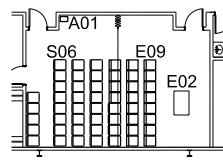

BLESSED SACRAMENT ALTERNATE LAYOUT

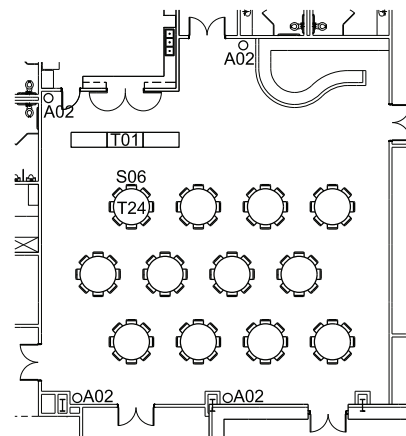

ACTIVITY CENTER ALTERNATE LAYOUT 1

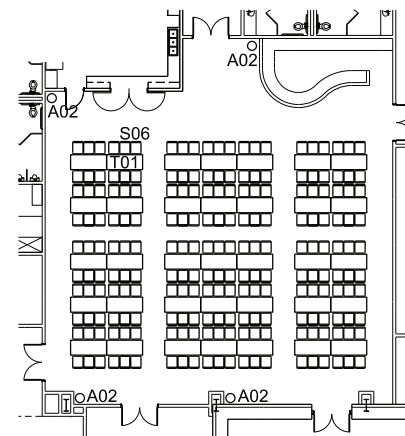

ACTIVITY CENTER ALTERNATE LAYOUT 2

FURNITURE AND EQUIPMENT LEGEND

ECCLESIASTICAL EQUIPMENT:

- E01 ALTAR
E02 ALTAR, SMALL
E03 COMMUNION TABLE*
E04 CREEDENCE TABLE*
E05 OFFERTORY TABLE
E06 LECTERN
E07 PULPIT
E08 PEW
E09 STACKING PEW CHAIR WITH KNEELER
E10 STANCEL CHAIR
E11 STACKING CHAIR FOR CHOIR
E12 BAPTISMAL FONT
E13 KNEELER/PRIE-DIEU WITH SCREEN
E14 ALTAR RAIL UNIT
E15 PORTABLE ALTAR

ACCESSORIES:

- A01 SMALL TRASH RECEPTACLE
A02 LARGE TRASH RECEPTACLE
A03 PAPER RECYCLE RECEPTACLE
A04 TOILET RECEPTACLE

DESKS AND STORAGE:

- | | |
|-----|--------------------------------|
| D01 | U-SHAPED WORKSTATION, R-RETURN |
| D02 | U-SHAPED WORKSTATION, L-RETURN |
| D03 | ADMINISTRATIVE WORKSTATION |
| D04 | NOT USED |
| D05 | NOT USED |
| D06 | NOT USED |
| D07 | NOT USED |
| D08 | NOT USED |
| D09 | NOT USED |
| D10 | LATERAL FILE W/ SHELVEING |

MISCELLANEOUS:

- M01 PORTABLE PODIUM
M02 MEDIUM EQUIPMENT CART
M03 SMALL EQUIPMENT CART
M04 ORGAN
M05 GRAND PIANO
M06 BABY GRAND PIANO
M07 UPRIGHT PIANO
M08 REFRIGERATOR
M09 RANGE
M10 DISHWASHER
M11 ICE MACHINE
M12 UNDERCOUNTER REFRIGERATOR
M13 MICROWAVE
M14 WARMING DRAWER
M15 KEYBOARD/SYNTHESIZER
M16 OUTDOOR FURNITURE*
M17 PORTABLE PROJECTOR
M18 TV, FLAT SCREEN
M19 MEDIA PLAYER
M20 NOT USED
M21 NOT USED
M22 NOT USED
M23 CRIB
M24 STAGE
M25 STAGE DOLLY
M26 KIOSK
M27 PORTABLE PROJECTION SCREEN
M44 CHILD CHECK-IN SYSTEM AND CART

SEATING:

- | | |
|-----|------------------------|
| S01 | DESK CHAIR |
| S02 | NOT USED |
| S03 | GUEST CHAIR |
| S04 | LOUNGE CHAIR |
| S05 | NOT USED |
| S06 | STACKING CHAIR |
| S07 | STACKING CHAIR DOLLY |
| S08 | NOT USED |
| S09 | NOT USED |
| S10 | SMALL CHILDREN'S CHAIR |
| S11 | NOT USED |
| S12 | ROCKER/GLIDER |

TABLES

- T01 MULTI-PURPOSE TABLE, 72" X 30"
T02 CHILDREN'S TABLE
T03 TABLE DOLLY (72" X 30" TABLE)
T04 LOBBY END TABLE
T05 END TABLE
T06 30" DIA TABLE
T24 MULTI-PURPOSE TABLE, 72" DIA
T25 TABLE DOLLY (FOR 72" DIA TABLE)

NOTES:

1. ITEMS IDENTIFIED WITH AN ASTERISK IN THE LEGEND ARE OPTIONAL. COORDINATE REQUIREMENT WITH THE USER.
2. REFER TO STANDARD DESIGN FUNCTIONAL/OPERATIONAL REQUIREMENTS FOR LOCATIONS OF MARKERBOARDS, PRESENTATION BOARDS AND SIMILAR TYPE ITEMS.
3. REFER TO STANDARD DESIGN FUNCTIONAL/OPERATIONAL REQUIREMENTS FOR LOCATIONS AND REQUIREMENTS FOR TOILET RECEPTACLES.

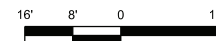

SCALE: 1/16" = 1'-0'



**US Army Corps
of Engineers®**
OMAHA DISTRICT

[illegible]

US ARMY ENGINEER DISTRICT CORPS OF ENGINEERS OMAHA, NEBRASKA	DESIGNED BY:		DATE:
	DWN BY:	CKD BY:	SOLICITATION NO.:
	WHB	WHB	CONTRACT NO.:
	SUBMITTED BY:		FILE NUMBER:
	PLOT SCALE:	PLOT DATE:	
	1:	PLOT DATE	
	SIZE:	FILE NAME:	

VARIOUS LOCATIONS
3D BIM TRANSLATION - ARMY STANDARD DESIGN
SMALL CHAPEL
ENHANCED COMMUNITY MINISTRY SERIES
FIRST FLOOR FURNITURE PLAN
ALTERNATE LAYOUTS

SHEET
IDENTIFICATION
I-111



**US Army Corps
of Engineers®**
OMAHA DISTRICT

[illegible]

US ARMY ENGINEER DISTRICT CORPS OF ENGINEERS OMAHA, NEBRASKA	DESIGNED BY:	DATE:
	DWN BY:	SOLICITATION NO.:
	LOH	Z
	WRB	CONTRACT NO.:
	SUBMITTED BY:	FILE NUMBER:
	PLOT SCALE:	PLOT DATE:
	1:1	Z
	SIZE:	FILE NAME:

VARIOUS LOCATIONS
3D BIM TRANSLATION - ARMY STANDARD DESIGN
SMALL CHAPEL
ENHANCED COMMUNITY MINISTRY SERIES
MEZZANINE FURNITURE PLAN

SHEET
IDENTIFICATION
I-120

FURNITURE AND EQUIPMENT LEGEND

ECCLESIASTICAL EQUIPMENT:

E01	ALTAR
E02	ALTAR, SMALL
E03	COMMUNION TABLE*
E04	CREDENCE TABLE*
E05	OFFERTORY TABLE
E06	LECTERN
E07	PULPIT
E08	PEW
E09	STACKING PEW CHAIR WITH KNEELER
E10	CHANCEL CHAIR
E11	STACKING CHAIR FOR CHOIR
E12	BAPTISMAL FONT
E13	KNEELER/PRIE-DIEU WITH SCREEN
E14	ALTAR RAIL UNIT
E15	PORTABLE ALTAR

ACCESSORIES:

A01 SMALL TRASH RECEPTACLE
A02 LARGE TRASH RECEPTACLE
A03 PAPER RECYCLE RECPTACLE
A04 TOILET RECEPTACLE

DESKS AND STORAGE:

D01 U-SHAPED WORKSTATION, R-RETURN
D02 U-SHAPED WORKSTATION, L-RETURN
D03 ADMINISTRATIVE WORKSTATION
D04 NOT USED
D05 NOT USED
D06 NOT USED
D07 NOT USED
D08 NOT USED
D09 NOT USED
D10 LATERAL FILE W/ SHELVING

MISCELLANEOUS:

M01 PORTABLE PODIUM
M02 MEDIUM EQUIPMENT CART
M03 SMALL EQUIPMENT CART
M04 ORGAN
M05 GRAND PIANO
M06 BABY GRAND PIANO
M07 UPRIGHT PIANO
M08 REFRIGERATOR
M09 RANGE
M10 DISHWASHER
M11 ICE MACHINE
M12 UNDERCOUNTER REFRIGERATOR
M13 MICROWAVE
M14 WARMING DRAWER
M15 KEYBOARD/SYNTHESIZER
M16 OUTDOOR FURNITURE*
M17 PORTABLE PROJECTOR
M18 TV, FLAT SCREEN
M19 MEDIA PLAYER
M20 NOT USED
M21 NOT USED
M22 NOT USED
M23 CRIB
M24 STAGE
M25 STAGE DOLLY
M26 KIOSK
M27 PORTABLE PROJECTION SCREEN
M44 CHILD CHECK-IN SYSTEM AND CART

SEATING:

S01	DESK CHAIR
S02	NOT USED
S03	GUEST CHAIR
S04	LOUNGE CHAIR
S05	NOT USED
S06	STACKING CHAIR
S07	STACKING CHAIR DOLLY
S08	NOT USED
S09	NOT USED
S10	SMALL CHILDREN'S CHAIR
S11	NOT USED
S12	ROCKER/GLIDER

TABLES:

T01 MULTI-PURPOSE TABLE, 72" X 30"
T02 CHILDREN'S TABLE
T03 TABLE DOLLY (72" X 30" TABLE)
T04 LOBBY END TABLE
T05 END TABLE
T06 30" DIA TABLE
T24 MULTI-PURPOSE TABLE, 72" DIA
T25 TABLE DOLLY (FOR 72" DIA TABLE)

NOTES:

1. ITEMS IDENTIFIED WITH AN ASTERISK IN THE LEGEND ARE OPTIONAL. COORDINATE REQUIREMENT WITH THE USER.
2. REFER TO STANDARD DESIGN FUNCTIONAL/OPERATIONAL REQUIREMENTS FOR LOCATIONS OF MARKERBOARDS, PRESENTATION BOARDS AND SIMILAR TYPE ITEMS.
3. REFER TO STANDARD DESIGN FUNCTIONAL/OPERATIONAL REQUIREMENTS FOR LOCATIONS, AND REQUIREMENTS FOR TOILET RECEPTACLES.



SCALE: 1/16" = 1'-0'

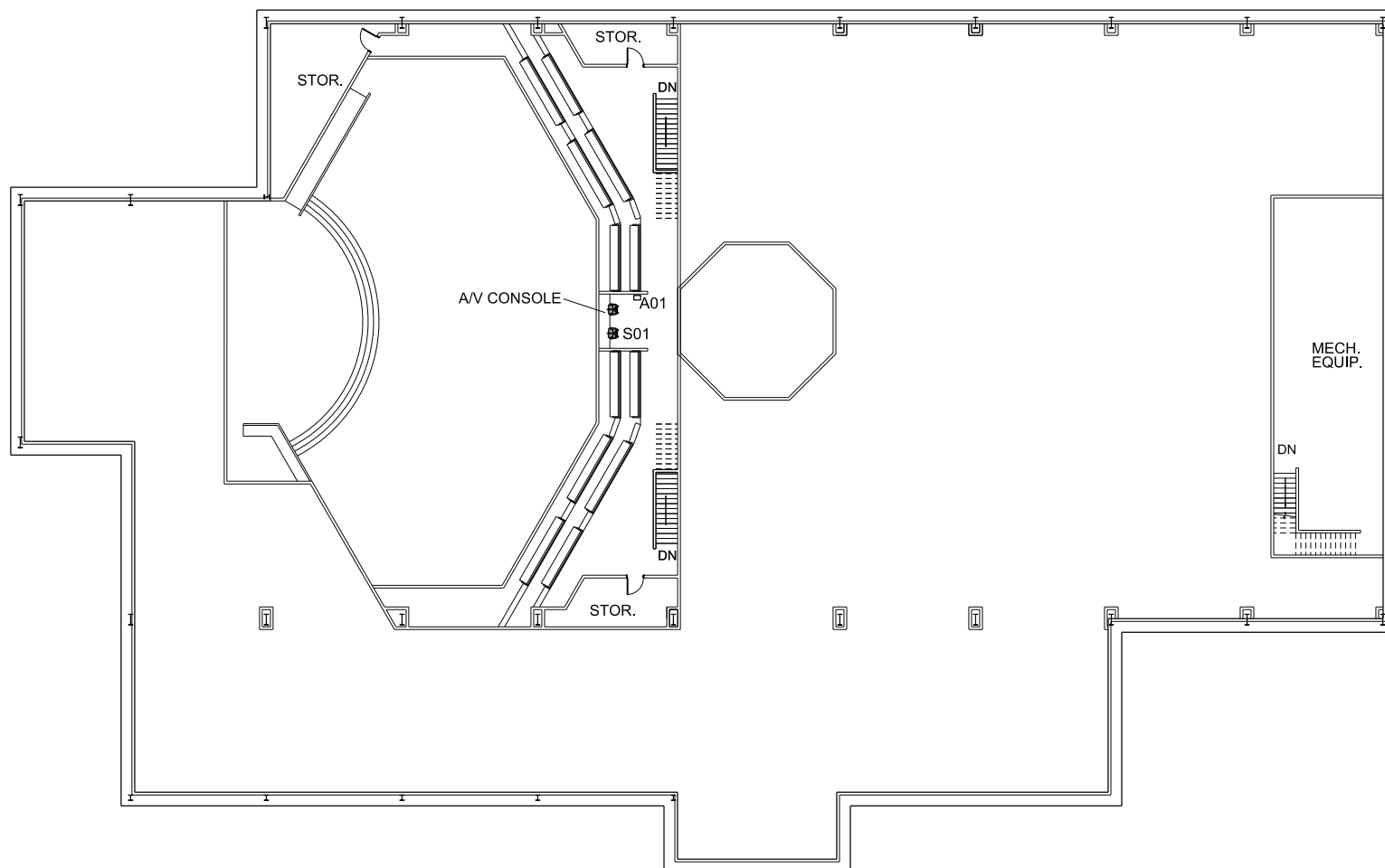

MEZZANINE FURNITURE PLAN

SCALE: 1/16" = 1'-0"